

S-1030 Series Sinter Burner

S-1030 LARGE CAPACITY BURNER FOR SINTER IGNITION FURNACE



FEATURES

- Large burner baffle protects internal metallic parts from furnace radiation
- Secure ignition of Coke Oven Gas (COG) through good mixing and high combustion velocity with short flame
- Rugged design with low maintenance
- Application-oriented construction
- High impulse with air pressure of only 15-30 mbar (6-12" w.c.)
- Full air impulse at only 1/3 of nominal burner capacity through three-way valve and special air baffle

CAPABILITIES

- Suitable for cold and warm air up to approximately 500°C (932°F)
- Excellent Turndown Range: 5:1 for gas, 10:1 for air
- Firing capability with various fuels

www.bloomeng.com

CAUTION: The improper use of combustion equipment can result in a condition hazardous to people and property. Users are urged to comply with National Safety Standards and/or Insurance Underwriters recommendations

S-1030 Burner Layout with 3-Way Valve and Special Baffle

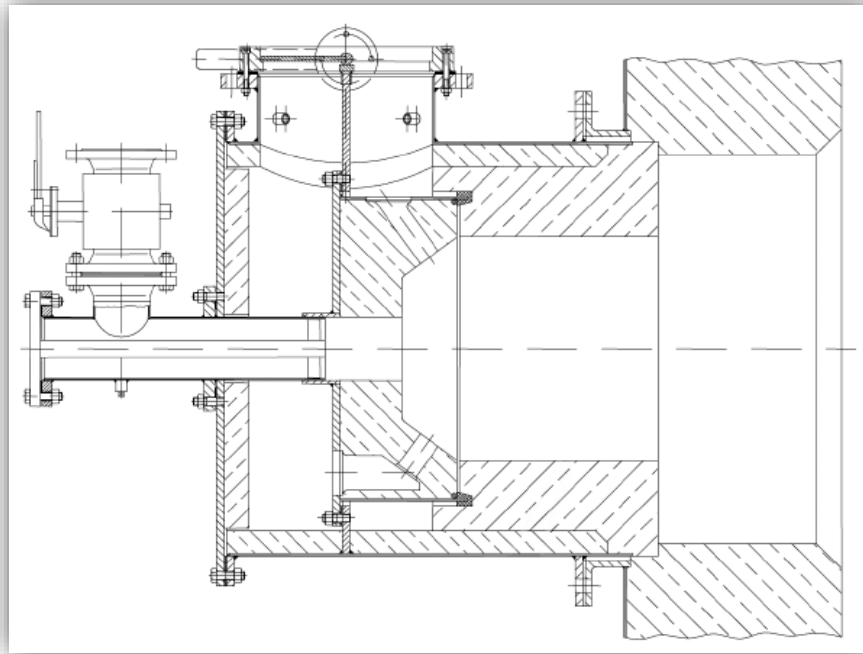

Combustion Services

- Detailed engineering for sinter burners and gas trains
- Supply and upgrade of sinter burners and peripheral equipment
- Ignition system design
- Rebuild, repair, and increasing of capacity of existing sinter burner systems
- Spare or replacement parts distribution
- General service and commissioning



Multiple Installations Around the World



www.bloomeng.com

India

South Africa

Spain

United Kingdom

Brazil

Germany

Italy

Morocco

Sweden

Austria

Turkey

Gabon

Taiwan

Korea