

MOTORIZED VALVE FOR PRIMARY FLOW SYSTEMS

DESIGNED FOR USE WITH CREST & FTXL BOILERS

When designing a primary flow boiler system isolating the non-firing boilers from the system is common practice. Lochinvar's two way motorized valve is designed for seamless operation with the Boiler. This helps to optimize the boiler system efficiency while saving energy.

When used with a boiler no external controller is required. The Smart Touch control powers the two way valve open and closed. In cascaded boiler systems the minimum number of valves that are always open is programmable using the Smart Touch control. Each valve is equipped with an external display that indicates the valves position.

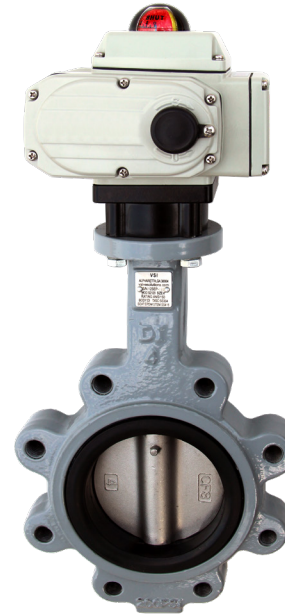

TWO WAY MOTORIZED VALVE DIMENSIONS & SPECIFICATIONS

SAP Number	Boiler Models	Pipe Size	Dimensions						Bolt Hole Pattern	NEMA 4 Certification
			A	B	C	D	E	F		
T00339077	FTX400 - 600	2"	3-1/4"	6-1/2"	3"	4"	10"	1-3/4"	4	Indoor
T00339075	FTX725 - 850	2-1/2"	3-1/4"	7"	3"	4"	10"	2"	4	Indoor
T00266962	FB 751 - 1251	3"	4"	7-1/4"	3-1/2"	5-1/4"	11"	2"	4	Indoor
T00312760	FB/OF 751 - 1251	3"	6-1/2"	7-1/4"	3-3/4"	5-3/4"	6-1/2"	2"	4	Yes
T00157681	FB 1501 - 4001	4"	5-1/4"	8"	4"	5-1/2"	11-1/2"	2"	8	Indoor
T00312791	FB/OF 1501 - 4001	4"	5-1/2"	8"	4-1/2"	5-3/4"	6-1/2"	2"	8	Yes
T00280019	FB/OF 5001 - 6001	6"	8-1/2"	9"	5-1/2"	6-1/4"	10"	2-1/4"	8	Yes

STANDARD FEATURES

- 120 VAC Actuator
- End Switch
- Certifications: CSA
- Maximum Working Pressure 200psi
- 416 Stainless Steel Stem
- 304 Stainless Steel Disc
- EPDM Seal
- Junction Box (Crest Only)
- 120 VAC Relay (Crest Only)

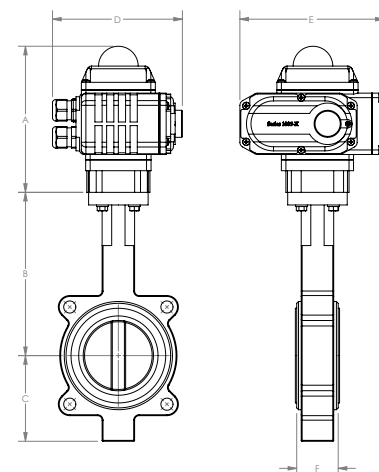

Image representation of NEMA 4 Certified Valve